

# CORNER RECORD

Agency Index \_\_\_\_\_

Document Number \_\_\_\_\_

City of BURBANK

County of LOS ANGELES

LOS ANGELES

California

Brief Legal Description CHERMAK STREET & DAMON WAY

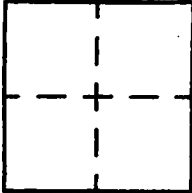

### CORNER TYPE

- Government Corner
- Meander
- Rancho
- Control
- Property
- Other

Date of Survey 4/19/21

### COORDINATES (Optional)

N. \_\_\_\_\_ E. \_\_\_\_\_

Elevation \_\_\_\_\_

Units  Metric  U.S. Survey Foot

Horizontal Datum \_\_\_\_\_

Zone \_\_\_\_\_ Epoch Date \_\_\_\_\_

Vertical Datum \_\_\_\_\_

Complies with Public Resources Code §§6801-6819

Complies with Public Resources Code §§6868-6902

PLS Act Ref:  8766(d)  8771  8773  Other: \_\_\_\_\_

Corner/Monument:  Left as found  Established  Rebuilt  Pre-Construction

Found and tagged  Reestablished  Referenced  Post-Construction

Narrative of corner identified and monument as found, set, reset, replaced, or removed:  
 See sheet #2 for description(s) :

### SURVEYOR'S STATEMENT

This Corner Record was prepared by me or under my direction in conformance with

the Professional Land Surveyors' Act on APRIL 19 2021

Signed David L. Lindell P.L.S. or R.C.E. No. LS 4016



### COUNTY SURVEYOR'S STATEMENT

This Corner Record was received \_\_\_\_\_,

and examined and filed \_\_\_\_\_,

Signed \_\_\_\_\_ P.L.S. or R.C.E. No. \_\_\_\_\_

Title \_\_\_\_\_

County Surveyor's Comment

FD. S & W RCE 13737  
PER CEFB 314-133  
RESET S&W LS 4016  
BY INTERSECTION OF  
TANGENT TIES

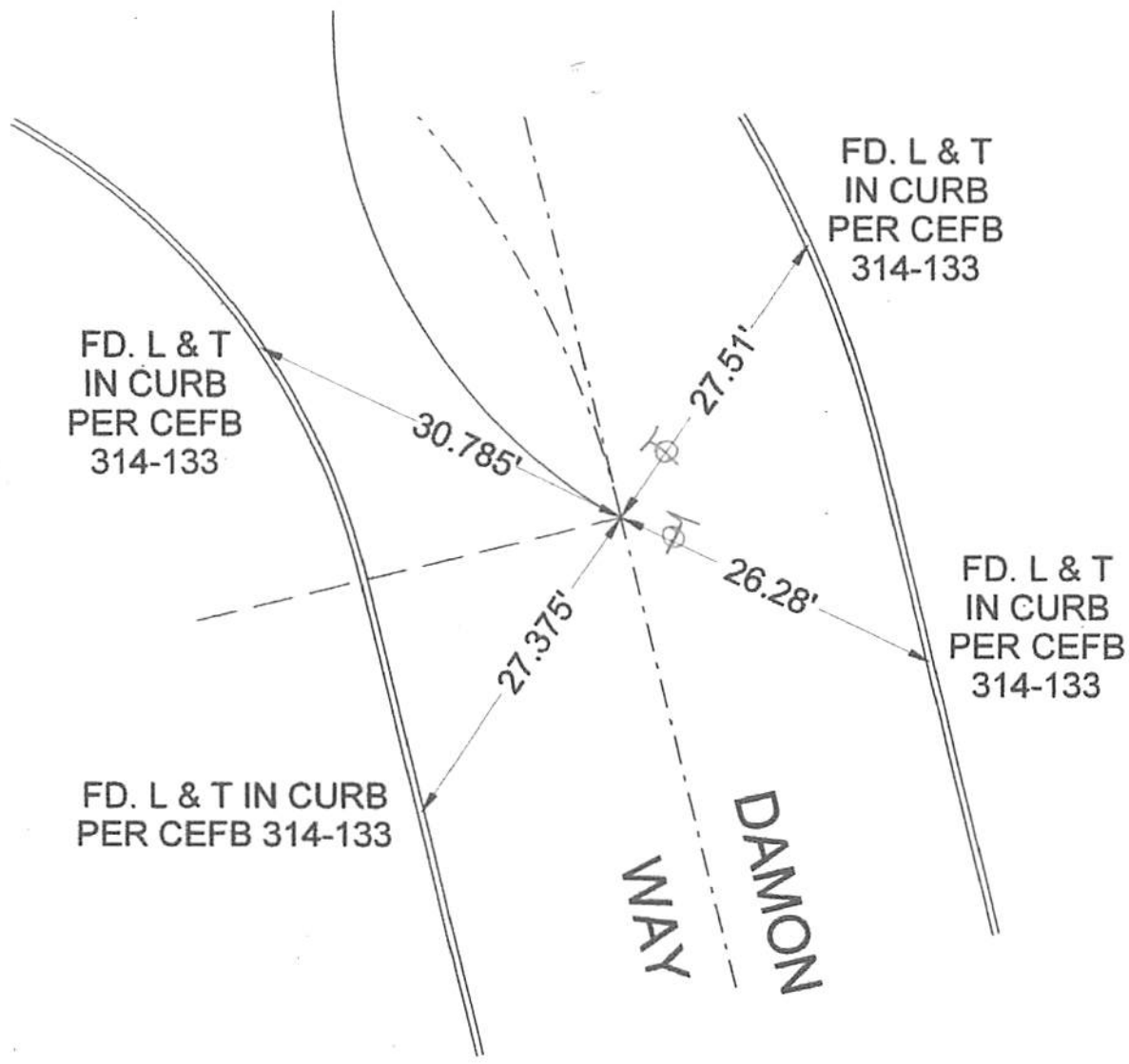

# CORNER RECORD

Agency Index \_\_\_\_\_

Document Number \_\_\_\_\_

City of BURBANK

County of LOS ANGELES, California

Brief Legal Description DAMON WAY S/O OF CHERMAK STREET

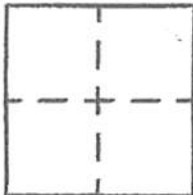

### CORNER TYPE

- Government Corner       Control  
 Meander                       Property  
 Rancho                               Other

Date of Survey 4/19/21

### COORDINATES (Optional)

N. \_\_\_\_\_ E. \_\_\_\_\_

Elevation \_\_\_\_\_

Units  Metric  U.S. Survey Foot

Horizontal Datum \_\_\_\_\_

Zone \_\_\_\_\_ Epoch Date \_\_\_\_\_

Vertical Datum \_\_\_\_\_

Complies with Public Resources Code §§8801-8819

Complies with Public Resources Code §§8890-8902

PLS Act Ref:  8766(d)       8771       8773       Other:

Corner/Monument:  Left as found       Established       Rebuilt       Pre-Construction  
 Found and tagged       Reestablished       Referenced       Post-Construction

Narrative of corner identified and monument as found, set, reset, replaced, or removed:

See sheet #2 for description(s) :

### SURVEYOR'S STATEMENT

This Corner Record was prepared by me or under my direction in conformance with

the Professional Land Surveyors' Act on APRIL 19 2021

Signed David L. Lindell P.L.S. or R.C.E. No. LS 4016



### COUNTY SURVEYOR'S STATEMENT

This Corner Record was received \_\_\_\_\_

and examined and filed \_\_\_\_\_

Signed \_\_\_\_\_ P.L.S. or R.C.E. No. \_\_\_\_\_

Title \_\_\_\_\_

County Surveyor's Comment