

Document Number

Agency Index

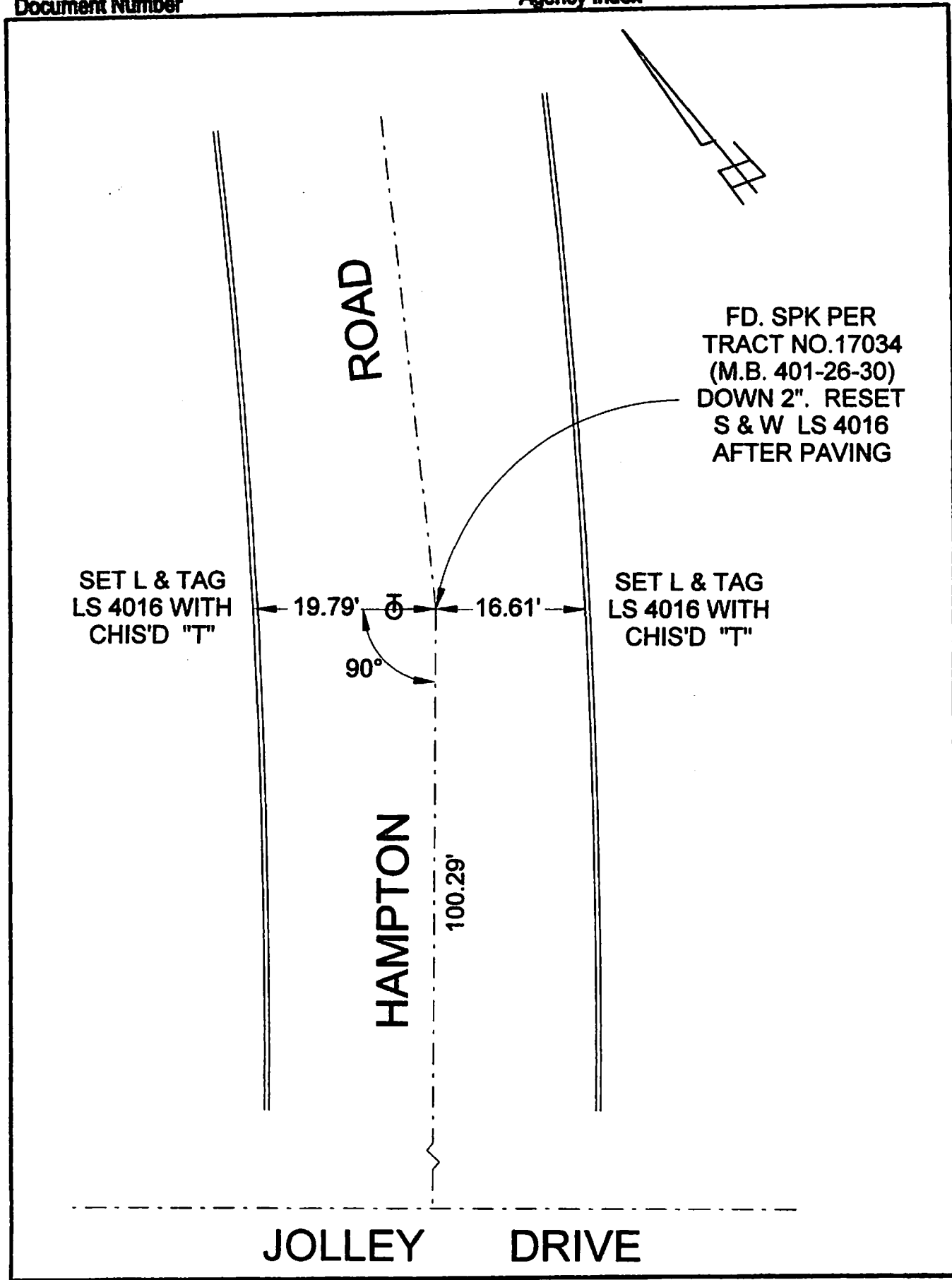

CORNER RECORD

Agency Index _____
Document Number _____
County of LOS ANGELES, California

City of BURBANK

Brief Legal Description HAMPTON ROAD P.I. NE/O JOLLEY DRIVE

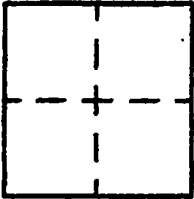

CORNER TYPE

- Government Corner
- Meander
- Rancho
- Control
- Property
- Other

Date of Survey 7/25/19

COORDINATES (Optional)

N. _____ E. _____
 Elevation _____
 Units Metric U.S. Survey Foot
 Horizontal Datum _____
 Zone _____ Epoch Date _____
 Vertical Datum _____
 Complies with Public Resources Code §§8901-8919
 Complies with Public Resources Code §§8920-8922

- PLS Act Ref: 8766(d) 8771 8773 Other _____
- Corner/Monument: Left as found Established Rebuilt Pre-Construction
 Found and tagged Reestablished Referenced Post-Construction

Narrative of corner identified and monument as found, set, reset, replaced, or removed:
 See sheet #2 for description(s) :

SURVEYOR'S STATEMENT

This Corner Record was prepared by me or under my direction in conformance with
 the Professional Land Surveyors' Act on JULY 26, 2019
 Signed David L. Lindell P.L.S. or R.C.E. No. LS 4016



COUNTY SURVEYOR'S STATEMENT

This Corner Record was received _____
 and examined and filed _____
 Signed _____ P.L.S. or R.C.E. No. _____
 Title _____
 County Surveyor's Comment _____

A.P.N.: N/A

T.G. 533-F-4