

FB 339 P. 61

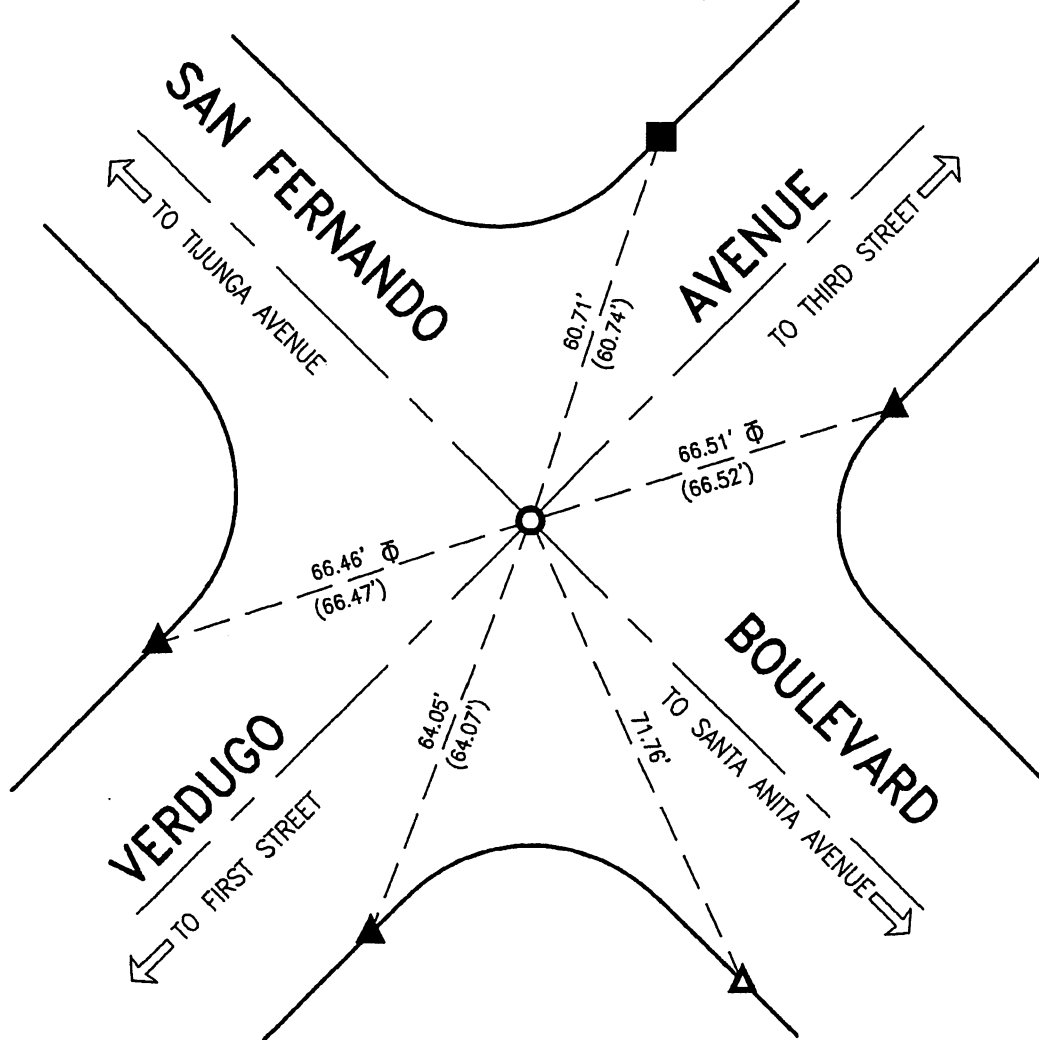

○ NOTHING FOUND, SET GEAR SPIKE W/ WASHER "LS 3983", PER R1, FLUSH.

▲ FOUND LEAD, TACK, & TAG "LS 5411", PER R1, FLUSH ON CURB.

■ FOUND LEAD, TACK, & TAG "C.E." PER R1, FLUSH ON CURB.

△ FOUND LEAD, TACK & TAG "LS 3983", PER R1, FLUSH ON CURB.

Φ INDICATES TANGENT TIE.

R1=PWFB 1719/1430-1431.

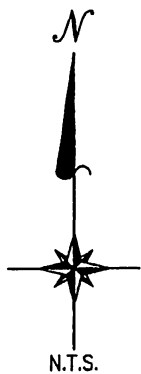

POST-CONSTRUCTION

THE PURPOSE OF THE RECORD IS TO DOCUMENT THE PERPETUATION OF FOUND MONUMENT(S) PURSUANT TO THE PLS ACT SECTION 8771. NO CLAIM IS MADE AS TO THE CORRECTNESS OF THE POSITION(S) OF SAID MONUMENT(S), NOR THE DIMENSIONAL RELATIONSHIP TO STREET CENTERLINES OR PROPERTY BOUNDARIES

# CORNER RECORD

PWFB 1719

1478

Document Number \_\_\_\_\_

City of BURBANK

County of LOS ANGELES, California

Brief Legal Description THE INTERSECTION OF VERDUGO AVENUE AND SAN FERNANDO BOULEVARD..

1308  
22952

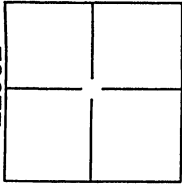

### CORNER TYPE

- Government Corner  Control
- Meander  Property
- Rancho  Other

Date of Survey JUNE 15, 2016

### COORDINATES(Optional)

- N. \_\_\_\_\_
- E. \_\_\_\_\_
- Zone \_\_\_\_\_ NAD27  NAD83
- NAD83 Epoch \_\_\_\_\_
- Elevation \_\_\_\_\_
- Vert. Datum: NGVD29  NAV88
- Meas. Units: Metric  Imperial

Corner - Left as found  Found and tagged  Established  Reestablished  Rebuilt

Identification and type of corner found: Evidence used to identify or procedure used to establish or reestablish the corner:  
LOCATED EXISTING SURVEY MONUMENT PRIOR TO CONSTRUCTION AND TIED OUT.

A description of the physical condition of the monument as found and as set or reset: \_\_\_\_\_  
SEE SHEET 2 OF 2

### SURVEYOR'S STATEMENT

This Corner Record was prepared by me or under my direction in conformance with the Land Surveyor's Act on JUNE 20, 2016.  
Signed [Signature] P.L.S. or R.G.E. Number 3983



### COUNTY SURVEYOR'S STATEMENT

This Corner Record was received 9/26/2016 and examined and filed NOV 28 2016.  
Signed [Signature] P.L.S. or R.G.E. Number 6388  
Title DEPUTY COUNTY SURVEYOR



County Surveyor's Comment \_\_\_\_\_