

REFERENCES

- R-1 = COUNTY OF LOS ANGELES PWFB 1818/1152-1153
- () = RECORD DISTANCE PER R-1
- [] = RECORD & MEASURED DISTANCE PER R-1
- ⊕ = TANGENT OVER
- T.C. = TOP OF CURB

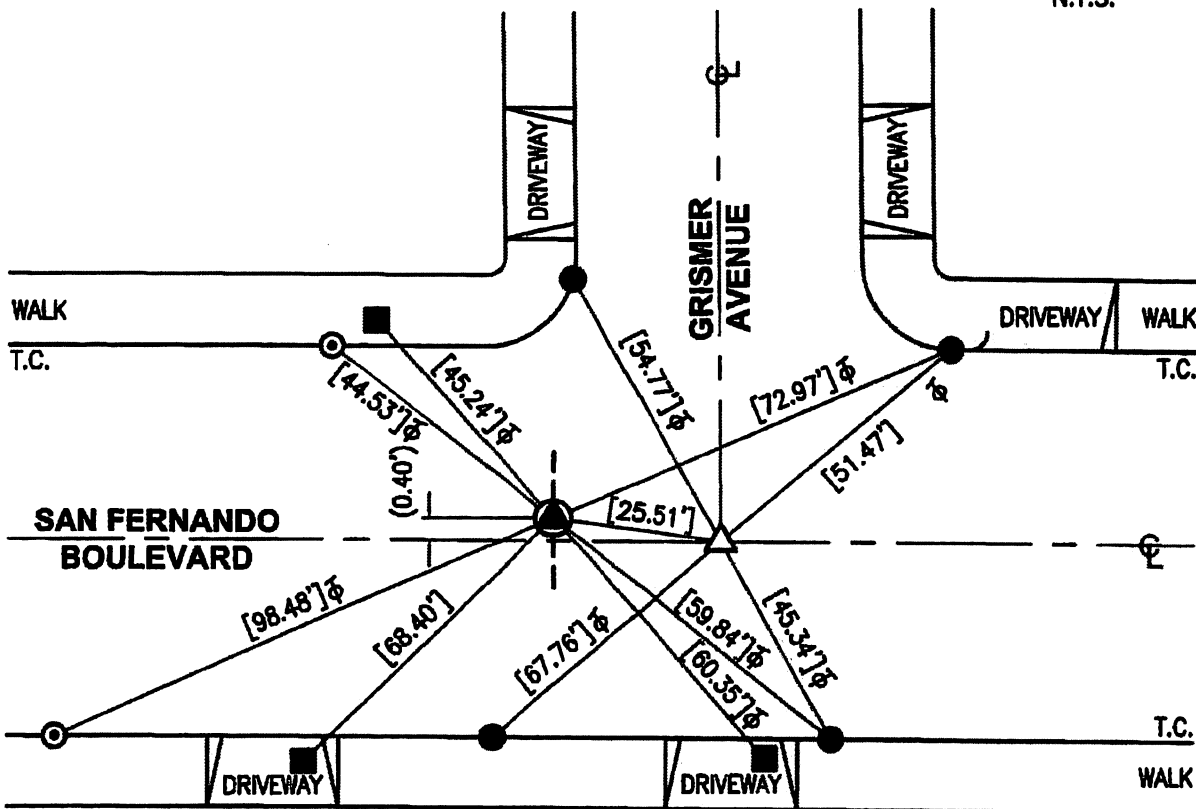

MONUMENT NOTES

- △ FOUND NOTHING, SET MAG SPIKE & BRASS WASHER STAMPED "LS 5411" PER TIES ON R-1, FLUSH, AFTER CONSTRUCTION.
- ⊕ FOUND DISK WITH PUNCHED "△" DOWN 2.0' IN WELL MONUMENT, ACCEPTED AS BUR. 1-2A TRAV. MON. PER R-1, AFTER CONSTRUCTION.
- FOUND LEAD, TACK & TAG "LS 5748" IN T.C. WITH CHISELED "T" BEHIND TIE POINT PER R-1.
- FOUND LEAD, TACK & TAG "CITY ENG" IN WALK PER R-1.
- ⊙ FOUND LEAD, TACK & TAG "LS 5411" IN T.C. WITH CHISELED "T" BEHIND TIE POINT PER R-1.

THE PURPOSE OF THIS RECORD IS TO DOCUMENT THE PERPETUATION OF FOUND MONUMENT(S) PURSUANT TO THE PLS ACT SECTION 8771. 17-EXC-400

CORNER RECORD

Agency Index 1190

Document Number _____

City of BURBANK

County of LOS ANGELES, California

Brief Legal Description SAN FERNANDO BOULEVARD & GRISMER AVENUE

CORNER TYPE

COORDINATES (Optional)

30438

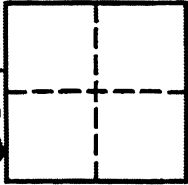

Government Corner Control
 Meander Property
 Rancho Other

N. _____ E. _____

Elevation _____

Units Metric U.S. Survey Foot

Horizontal Datum _____

Zone _____ Epoch Date _____

Vertical Datum _____

Date of Survey 3/26/2018

Complies with Public Resources Code §§8801-8819

Complies with Public Resources Code §§8890-8902

PLS Act Ref: 8765 (d) 8771 8773 Other:

Corner/Monument: Left as found Established Rebuilt Pre-Construction

Found and tagged Reestablished Referenced Post-Construction

Narrative of corner identified and monument as found, set, reset, replaced, or removed:

See sheet #2 for description (s):

SURVEYOR'S STATEMENT

This Corner Record was prepared by me or under my direction in conformance with the Professional Land Surveyors' Act on 6/7/2018

Signed _____ P.L.S. or R.C.E. No. 5411



COUNTY SURVEYOR'S STATEMENT

This Corner Record was received JUN 18 2018

and examined and filed OCT 30 2018

Signed Curt M. O'Bryan P.L.S. or R.C.E. No. 6388

Title DEPUTY COUNTY SURVEYOR

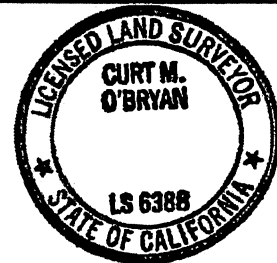

County Surveyor's Comment _____