

REFERENCES

- R-1 = COUNTY OF LOS ANGELES PWFB 1819/1359-1360
- [] = RECORD & MEASURED DISTANCE PER R-1
- ⌀ = TANGENT OVER
- T.C. = TOP OF CURB
- MH = MANHOLE
- TS = TRAFFIC SIGNAL
- WCR = WHEEL CHAIR RAMP

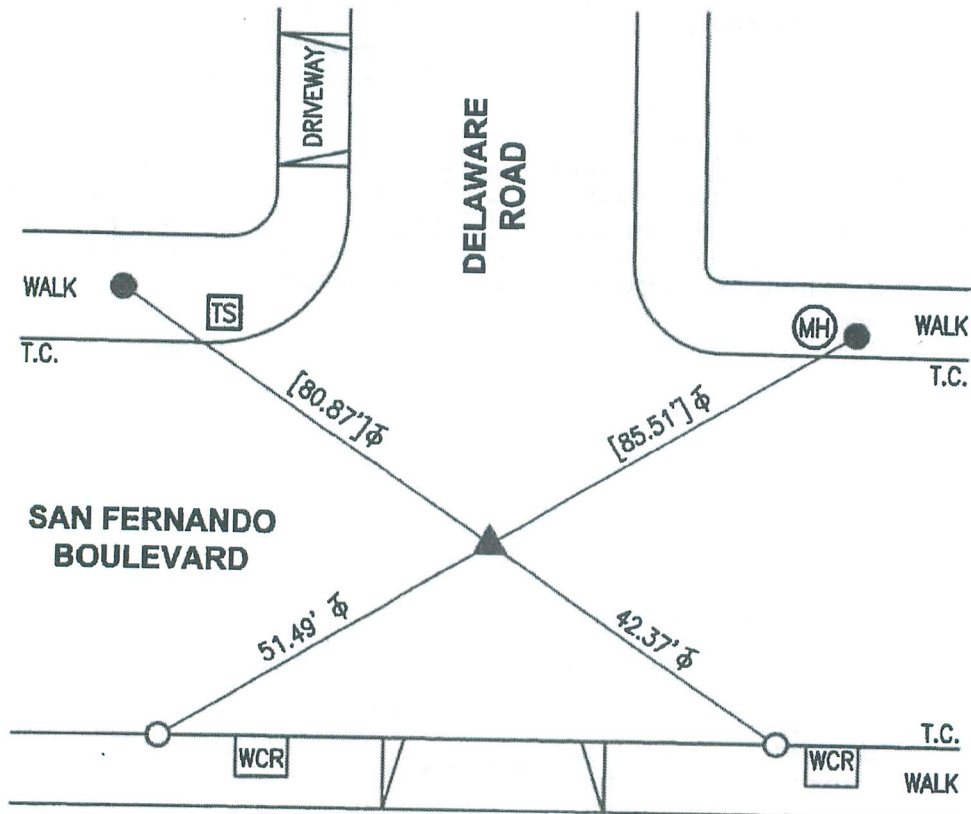

MONUMENT NOTES

- ▲ FOUND SPIKE & WASHER "LS 6771" PER R-1, FLUSH, AFTER CONSTRUCTION.
- FOUND LEAD, TACK & TAG "CITY ENG" WITH CHISELED "T" BEHIND TIE POINT IN WALK PER R-1.
- SET LEAD, TACK & TAG "LS 5411" IN T.C.

THE PURPOSE OF THIS RECORD IS TO DOCUMENT THE PERPETUATION OF FOUND MONUMENT(S) PURSUANT TO THE PLS ACT SECTION 8771. 17-EXC-400



FWB 1819

CORNER RECORD

Agency Index 1379

Document Number _____

City of BURBANK

County of LOS ANGELES, California

Brief Legal Description SAN FERNANDO BOULEVARD & DELAWARE ROAD

30439

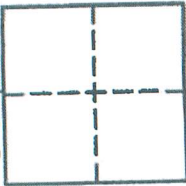

CORNER TYPE

Government Corner Control
Meander Property
Rancho Other

Date of Survey 3/26/2018

COORDINATES (Optional)

N. _____ E. _____

Elevation _____

Units Metric U.S. Survey Foot

Horizontal Datum _____

Zone _____ Epoch Date _____

Vertical Datum _____

Complies with Public Resources Code §§8801-8819

Complies with Public Resources Code §§8890-8902

PLS Act Ref: 8765(d) 8771 8773 Other:

Corner/Monument: Left as found Established Rebuilt Pre-Construction

Found and tagged Reestablished Referenced Post-Construction

Narrative of corner identified and monument as found, set, reset, replaced, or removed:
 See sheet #2 for description (s):

SURVEYOR'S STATEMENT

This Corner Record was prepared by me or under my direction in conformance with the Professional Land Surveyors' Act on 6/7/2018

Signed [Signature] P.L.S. or R.C.E. No. 5411



COUNTY SURVEYOR'S STATEMENT

This Corner Record was received JUN 18 2018

and examined and filed OCT 30 2018

Signed [Signature] P.L.S. or R.C.E. No. 6388

Title DEPUTY COUNTY SURVEYOR

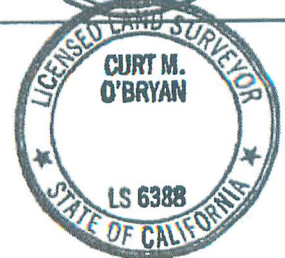

County Surveyor's Comment _____
