

R-1 = CITY OF BURBANK TIE SHEET FB 278/61
 () = RECORD DISTANCE PER R-1

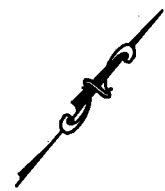

NTS

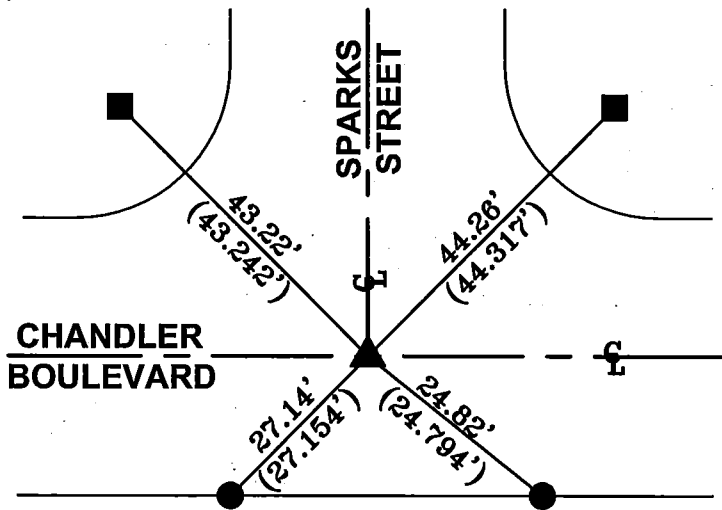

▲ FD PUNCHED SPK/W "LA CO FLOOD CONTROL" FLUSH PER R-1 BEFORE CONSTRUCTION. SET MAG. NAIL/W "LS 5411" TAG FLUSH PER TIES HEREON AFTER CONSTRUCTION.

● FD L/T IN T.C. PER R-1

■ FD L/T IN WALK PER R-1.

THE PURPOSE OF THIS RECORD IS TO DOCUMENT THE PERPETUATION OF FOUND MONUMENT(S) PURSUANT TO THE PLS ACT SECTION 8771. NO CLAIM IS MADE REGARDING THE CORRECTNESS OF THE POSITION(S) OF SAID MONUMENT(S), NOR THE DIMENSIONAL RELATIONSHIP TO STREET CENTERLINES OF PROPERTY BOUNDARIES.

11-TOR-759

CORNER RECORD

PWFB 1718

1244

City of Burbank

Document Number _____

County of Los Angeles, California

Brief Legal Description Sparks Street & Chandler Boulevard

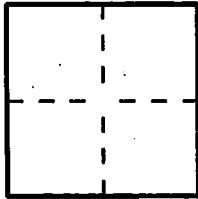

CORNER TYPE

Government Corner Control

Meander Property

Rancho Other

Date of Survey 01/27/11

COORDINATES (Optional)

N. _____

E. _____

Zone NAD27 NAD83

NAD83 Epoch _____

Elevation _____

Vertical Datum: NGVD29 NAVD88

Units: Metric Imperial U.S. Survey

Corner — Left as found Found and tagged Established Reestablished Rebuilt

Identification and type of corner found; Evidence used to identify or procedure used to establish or reestablish the corner:
Found as described on the reverse of this sheet.

A description of the physical condition of the monument as found and as set or reset: _____

See Sheet 2

SURVEYOR'S STATEMENT

This Corner Record was prepared by me or under my direction in conformance with the Professional Land Surveyors' Act on September 7, 2011

Signed [Signature] P.L.S. or R.C.E. No. L.S. 5411

COUNTY SURVEYOR'S STATEMENT

This Corner Record was received SEP 15 2011

examined and filed OCT 12 2011

Signed [Signature] P.L.S. or R.C.E. No. 6388

Title DEPUTY COUNTY SURVEYOR

County Surveyor's Comment _____

