

CORNER RECORD

PWFB 1718

Document Number

1230

City of Burbank

County of Los Angeles

California

Brief Legal Description Pepper Street & Jeffries Avenue

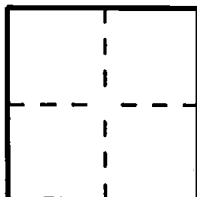

CORNER TYPE

Government Corner [] Control [x]
Meander [] Property []
Rancho [] Other []
Date of Survey 01/27/11

COORDINATES (Optional)

N.
E.
Zone NAD27 [] NAD83 []
NAD83 Epoch
Elevation.
Vertical Datum: NGVD29 [] NAVD88 []
Units: Metric [] Imperial [] U.S. Survey [x]

Corner — Left as found [] Found and tagged [] Established [] Reestablished [x] Rebuilt []

Identification and type of corner found; Evidence used to identify or procedure used to establish or reestablish the corner: Found as described on the reverse of this sheet.

A description of the physical condition of the monument as found and as set or reset:

See Sheet 2

SURVEYOR'S STATEMENT

This Corner Record was prepared by me or under my direction in conformance with the Professional Land Surveyors' Act on September 7, 2011

Signed [Signature] P.L.S. or R.C.E. No. L.S. 5411



COUNTY SURVEYOR'S STATEMENT

This Corner Record was received SEP 15 2011 examined and filed OCT 12 2011

Signed [Signature] P.L.S. or R.C.E. No. 6388
Title DEPUTY COUNTY SURVEYOR



County Surveyor's Comment

R-1 = CITY OF BURBANK TIE SHEET FB 187/108
 [] = RECORD & MEASURED DISTANCE PER R-1
 ϕ = TANGENT OVER

FB 339 P. 1

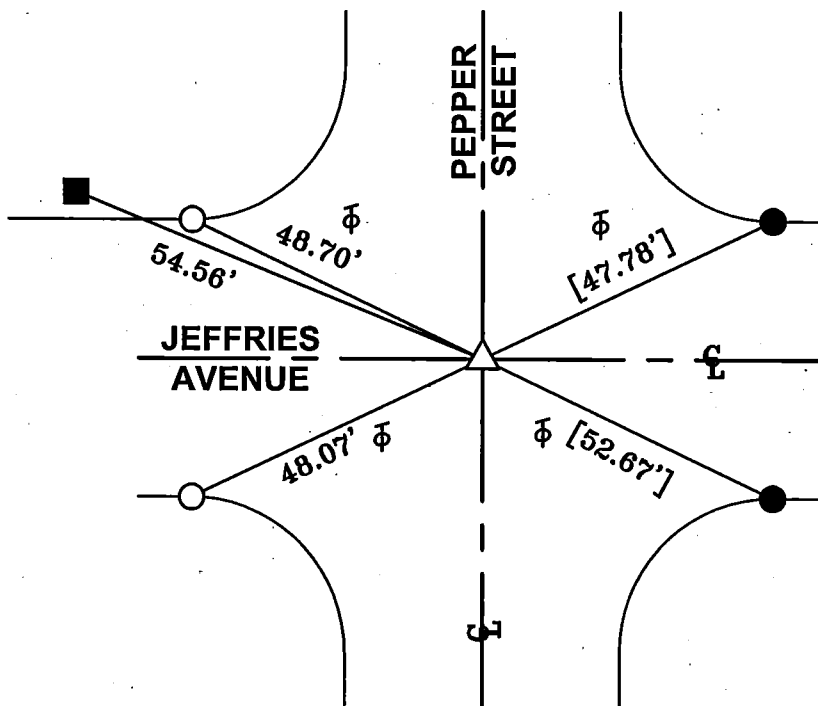

△ FD NOTHING, SET TEMP PK FLUSH PER TIES ON R-1 BEFORE CONSTRUCTION. SET MAG. NAIL/W "LS 5411" TAG FLUSH PER TIES HEREON AFTER CONSTRUCTION.

- FD L/T IN T.C. PER R-1.
- FD L/T IN CATCH BASIN NO REF.
- SET L/T "LS 5411" IN T.C.