

- R-1 = COUNTY OF LOS ANGELES PWFB 1819/146-147
- () = RECORD DISTANCE PER R-1
- [] = RECORD & MEASURED DISTANCE PER R-1
- R-2 = COUNTY OF LOS ANGELES PWFB 1819/388-389
- < > = RECORD & MEASURED DISTANCE PER R-2
- R-3 = CITY OF BURBANK TIE SHEET BOOK 265, PAGE 46
- (()) = RECORD & MEASURED DISTANCE PER R-3
- ⊕ = TANGENT OVER

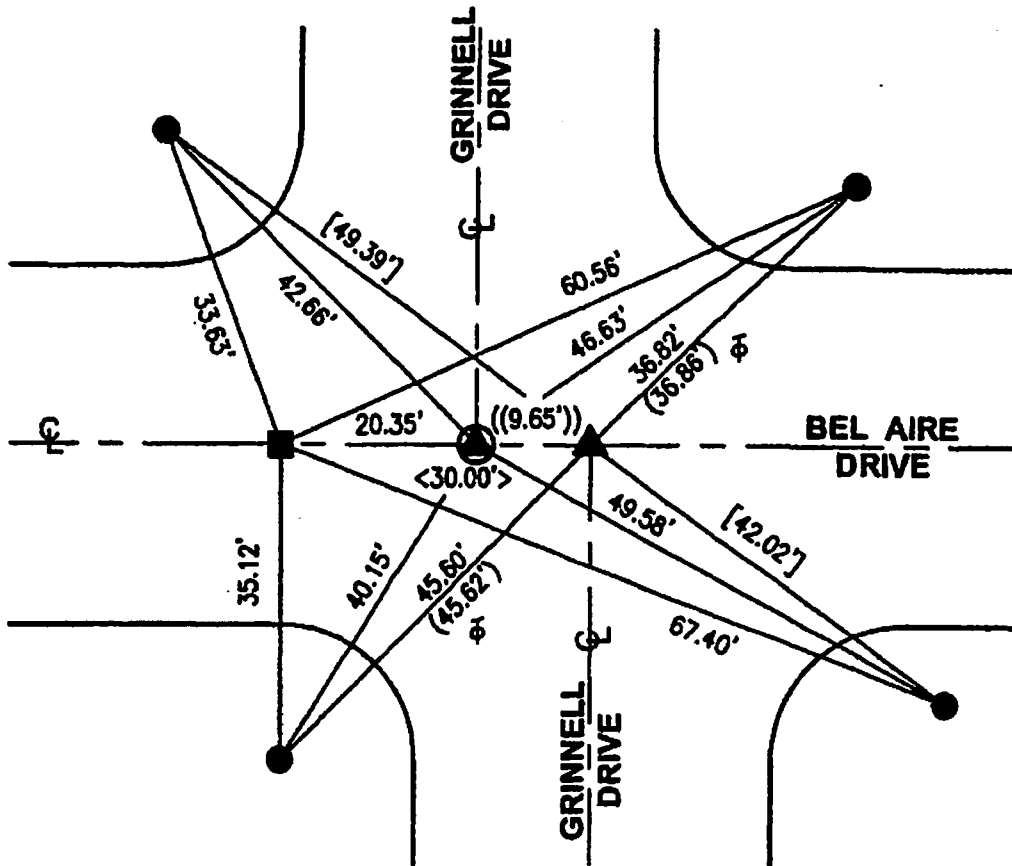
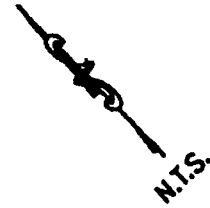

- ▲ FD. S/W "C.E." FLUSH PER R-1 & R-3 BEFORE CONSTRUCTION. SET MAG. N/W "LS 5411" FLUSH PER TIES HEREON AFTER CONSTRUCTION.
- FD. MAG. N/W "PLS 5691" FLUSH NO REF., FITS DISTANCE PER R3 BEFORE CONSTRUCTION. SET MAG. N/W "LS 5411" FLUSH PER TIES HEREON AFTER CONSTRUCTION.
- FD. MAG. N/W "RCE 14356" FLUSH PER R-2 BEFORE CONSTRUCTION. SET MAG. N/W "LS 5411" FLUSH PER TIES HEREON AFTER CONSTRUCTION.
- FD L/RIVET & CHISELED "T" FLUSH IN WALK PER R-1 & R-3.

THE PURPOSE OF THIS RECORD IS TO DOCUMENT THE PERPETUATION OF FOUND MONUMENT(S) PURSUANT TO THE PLS ACT SECTION 8771. NO CLAIM IS MADE REGARDING THE CORRECTNESS OF THE POSITION(S) OF SAID MONUMENT(S), NOR THE DIMENSIONAL RELATIONSHIP TO STREET CENTERLINES OR PROPERTY BOUNDARIES.

13-TRO-278

CORNER RECORD

Document Number **PWFB 1819 909**

City of BURBANK County of LOS ANGELES, California

Brief Legal Description BEL AIRE DRIVE & GRINNELL DRIVE

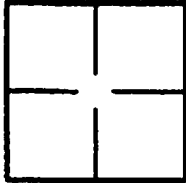

CORNER TYPE

- Government Corner Control
- Meander Property
- Rancho Other

Date of Survey 4/8/2013 & 5/16/2013

COORDINATES (Optional)

N. _____
 E. _____
 Zone _____ NAD27 NAD83
 NAD83 Epoch _____
 Elevation _____
 Vertical Datum: NGVD29 NAVD83
 Units: Metric Imperial U.S. Survey

Corner — Left as found Found and tagged Established Reestablished Rebuilt

Identification and type of corner found; Evidence used to identify or procedure used to establish or reestablish corner:
Found as described on the reverse of this sheet.

A description of the physical condition of the monument as found and as set or reset:
See Page 2

SURVEYOR'S STATEMENT

This Corner Record was prepared by me or under my direction in conformance with the Professional Land Surveyors' Act on 5/21/2013

Signed [Signature] P.L.S. or R.C.E. No. L.S. 5411



COUNTY SURVEYOR'S STATEMENT

This Corner Record was received JUN 04 2013

examined and filed JUN 26 2013

Signed [Signature] P.L.S. or R.C.E. No. 6388

Title DEPUTY COUNTY SURVEYOR



County Surveyor's Comment _____