

R-1 = CITY OF BURBANK TIE SHEET BOOK 331, PAGE 130
 () = RECORD DISTANCE PER R-1
 [] = RECORD & MEASURED DISTANCE PER R-1
 ⌀ = TANGENT OVER

FB 338 P.337

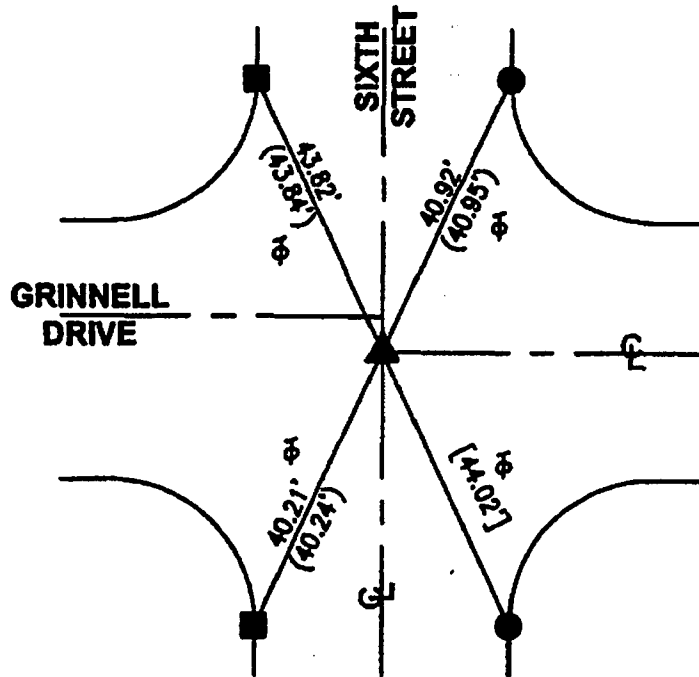
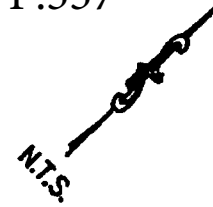

▲ FD. PUNCHED FLAT HD. SQ. SPK/W "C.E." FLUSH PER R-1 BEFORE CONSTRUCTION. SET MAG. N/W "LS 5411" FLUSH PER TIES HEREON AFTER CONSTRUCTION.

● FD. L/T "C.E." & CHISELED "T" IN T.C. PER R-1.

■ FD L/R & CHISELED "T" IN T.C. PER R-1.

THE PURPOSE OF THIS RECORD IS TO DOCUMENT THE PERPETUATION OF FOUND MONUMENT(S) PURSUANT TO THE PLS ACT SECTION 8771. NO CLAIM IS MADE REGARDING THE CORRECTNESS OF THE POSITION(S) OF SAID MONUMENT(S), NOR THE DIMENSIONAL RELATIONSHIP TO STREET CENTERLINES OR PROPERTY BOUNDARIES.

13-TRO-276

CORNER RECORD

Document Number PWFB 1819 939

City of BURBANK County of LOS ANGELES, California

Brief Legal Description SIXTH STREET & GRINNELL DRIVE

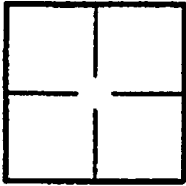

CORNER TYPE

- Government Corner Control
- Meander Property
- Rancho Other

Date of Survey 4/8/2013 & 5/16/2013

COORDINATES (Optional)

N. _____
 E. _____
 Zone _____ NAD27 NAD83
 NAD83 Epoch _____
 Elevation _____
 Vertical Datum: NGVD29 NAVD88
 Units: Metric Imperial U.S. Survey

Corner — Left as found Found and tagged Established Reestablished Rebuilt

Identification and type of corner found; Evidence used to identify or procedure used to establish or reestablish corner:
Found as described on the reverse of this sheet.

A description of the physical condition of the monument as found and as set or reset:
See Page 2

SURVEYOR'S STATEMENT

This Corner Record was prepared by me or under my direction in conformance with the Professional Land Surveyors' Act on 5/21/2013

Signed [Signature] P.L.S. or R.C.E. No. LS. 5411



COUNTY SURVEYOR'S STATEMENT

This Corner Record was received JUN 04 2013 JUL 08 2013

examined and filed JUL 10 2013

Signed [Signature] P.L.S. or R.C.E. No. 6388

Title DEPUTY COUNTY SURVEYOR

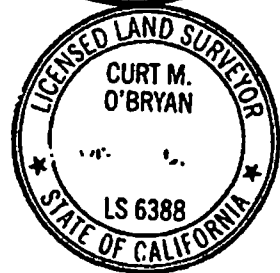

County Surveyor's Comment _____