

# CORNER RECORD

INDEX \_\_\_\_\_ PAGE \_\_\_\_\_

City of BURBANK

County of Los Angeles, California

Brief Legal Description: ROSE STREET & WARNER BOULEVARD

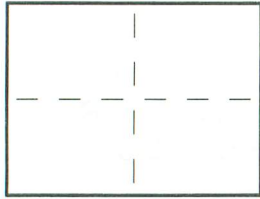

### CORNER TYPE

- Govt. Corner
- Meander
- Rancho
- Date of Survey: 5/26/15
- Control
- Property
- Other

### COORDINATES (optional)

N. \_\_\_\_\_  
 E. \_\_\_\_\_  
 Zone \_\_\_\_\_ Datum \_\_\_\_\_  
 Elev. \_\_\_\_\_

- Corner —  Left as Found  Found & Tagged  Established  
 Reestablished  Rebuilt

**Identification & Type of Corner Found:** Evidence used to identify or procedure used to establish or reestablish the corner.

SEE PLAT

A Description of the Physical Condition of the Monument as Found and as Set or Reset: \_\_\_\_\_

SEE PLAT

### Surveyor's Statement

This Corner Record was Prepared by Me or Under My Direction in Conformance with the Land Surveyors Act on MAY 29, 2015 19 \_\_\_\_.

Signed: David L. Lindell

L.S. or R.C.E. No.: LS 4016

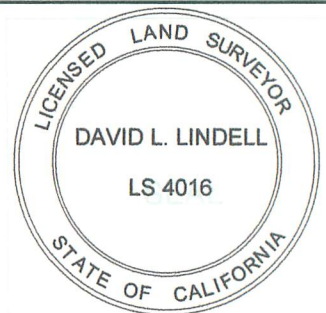

### County Surveyor's Statement

This Corner Record was Received \_\_\_\_\_ 19 \_\_\_\_ and Examined and Filed \_\_\_\_\_ 19 \_\_\_\_.

Signed: \_\_\_\_\_

Title: \_\_\_\_\_

County Surveyor's Comment: \_\_\_\_\_

T.G. 563-D-5