

CORNER RECORD

INDEX _____ PAGE _____

City of BURBANK

County of Los Angeles, California

Brief Legal Description: PALM AVENUE S/W/O SAN FERNANDO BLVD ("THE PASEO")

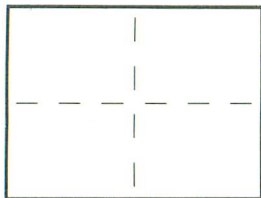

CORNER TYPE

COORDINATES (optional)

- Govt. Corner
- Meander
- Rancho
- Date of Survey: 5/17/15
- Control
- Property
- Other

N. _____
 E. _____
 Zone _____ Datum _____
 Elev. _____

- Corner — Left as Found Found & Tagged Established
 Reestablished Rebuilt

Identification & Type of Corner Found: Evidence used to identify or procedure used to establish or reestablish the corner.

SEE PLAT

A Description of the Physical Condition of the Monument as Found and as Set or Reset: _____

SEE PLAT

Surveyor's Statement

This Corner Record was Prepared by Me or Under My Direction in Conformance with the Land Surveyors Act on MAY 4, 2015

Signed: David L. Lindell

L.S. or R.C.E. No.: LS 4016

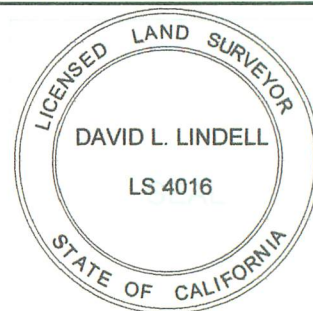

County Surveyor's Statement

This Corner Record was Received _____ and Examined and Filed _____

Signed: _____

Title: _____

County Surveyor's Comment: _____