

FB 337 P. 231

R-1 = CITY OF BURBANK F.B. 322 PG 43  
 L = REC. DIST. PER R-1.

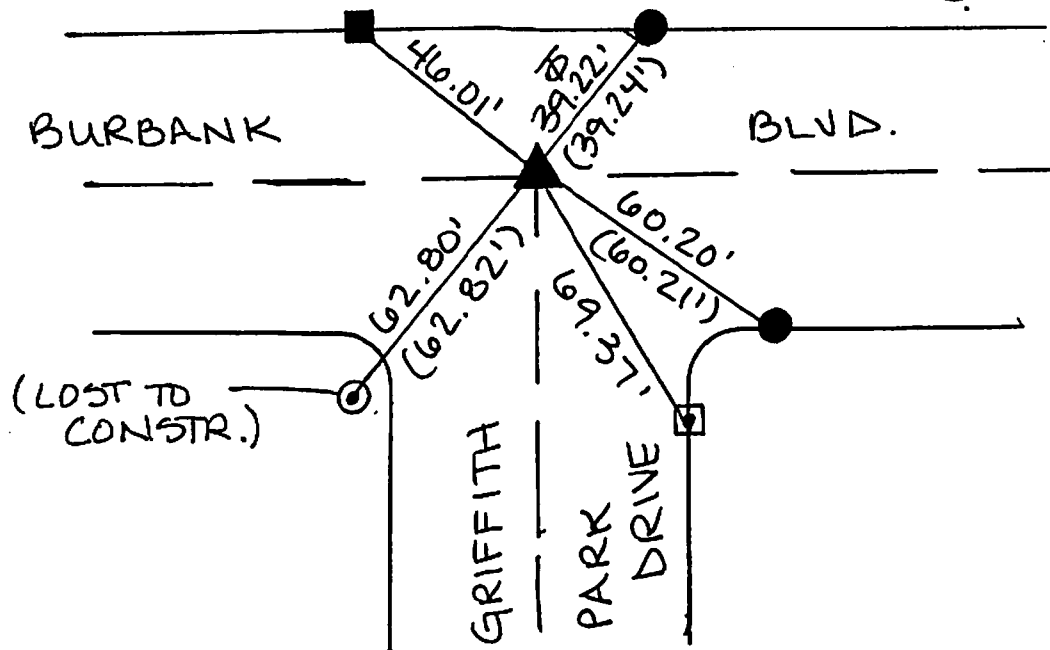
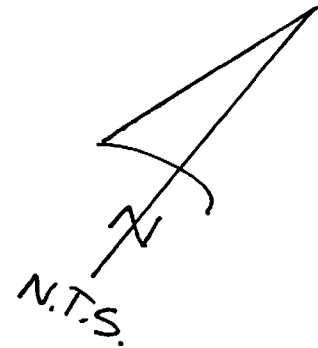

- ▲ FD. SPK. & C.E WASHER FLUSH (PER R-1) PRIOR TO CONSTR. SET SPK W L.S. 5411 AFTER CONSTR.
- FD. L/T W/CHIS. 'T' INT.C. (PER R-1). ADDED TAG L.S. 5411.
- ⊙ FD. L & C.E TAG W/CHIS. 'T' IN WALK (PER R-1).
- FD. L & C.E TAG W/CHIS. 'T' INT.C. (NO REF.)
- ⊠ FD. L/T INT.C. (NO REF.) ADDED TAG L.S. 5411.

The purpose of this record is to document the perpetuation of found monument(s) pursuant to the PLS Act Section 8771. No claim is made regarding the correctness of the position(s) of said monument(s), nor the dimensional relationship to street centerlines or property boundaries.

07-ALL-707

CORNER RECORD

PWFB 1718

Document Number 994

City of Burbank County of Los Angeles, California  
Brief Legal Description Burbank Blvd & Griffith Park Drive

COORDINATES (Optional)

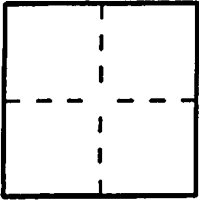

CORNER TYPE

Government Corner  Control   
Meander  Property   
Rancho  Other   
Date of Survey 3/27/08

N. \_\_\_\_\_  
E. \_\_\_\_\_  
Zone \_\_\_\_\_ NAD27  NAD83   
NAD83 Epoch \_\_\_\_\_  
Elevation. \_\_\_\_\_  
Vertical Datum: NGVD29  NAVD88   
Units: Metric  Imperial  U.S. Survey

Corner — Left as found  Found and tagged  Established  Reestablished  Rebuilt

Identification and type of corner found; Evidence used to identify or procedure used to establish or reestablish the corner.  
Found as described on the reverse of this sheet.

A description of the physical condition of the monument as found and as set or reset: \_\_\_\_\_

See Sheet 2

SURVEYOR'S STATEMENT

This Corner Record was prepared by me or under my direction in conformance with the Professional Land Surveyors' Act on April 19, 2008

Signed [Signature] P.L.S. or R.C.E. No. L.S. 5411



COUNTY SURVEYOR'S STATEMENT

This Corner Record was received JUL 08 2008  
examined and filed JUL 30 2008

Signed [Signature] P.L.S. or R.C.E. No. 6388

Title DEPUTY COUNTY SURVEYOR



County Surveyor's Comment \_\_\_\_\_

LA 15730