

FB-336 P. 17

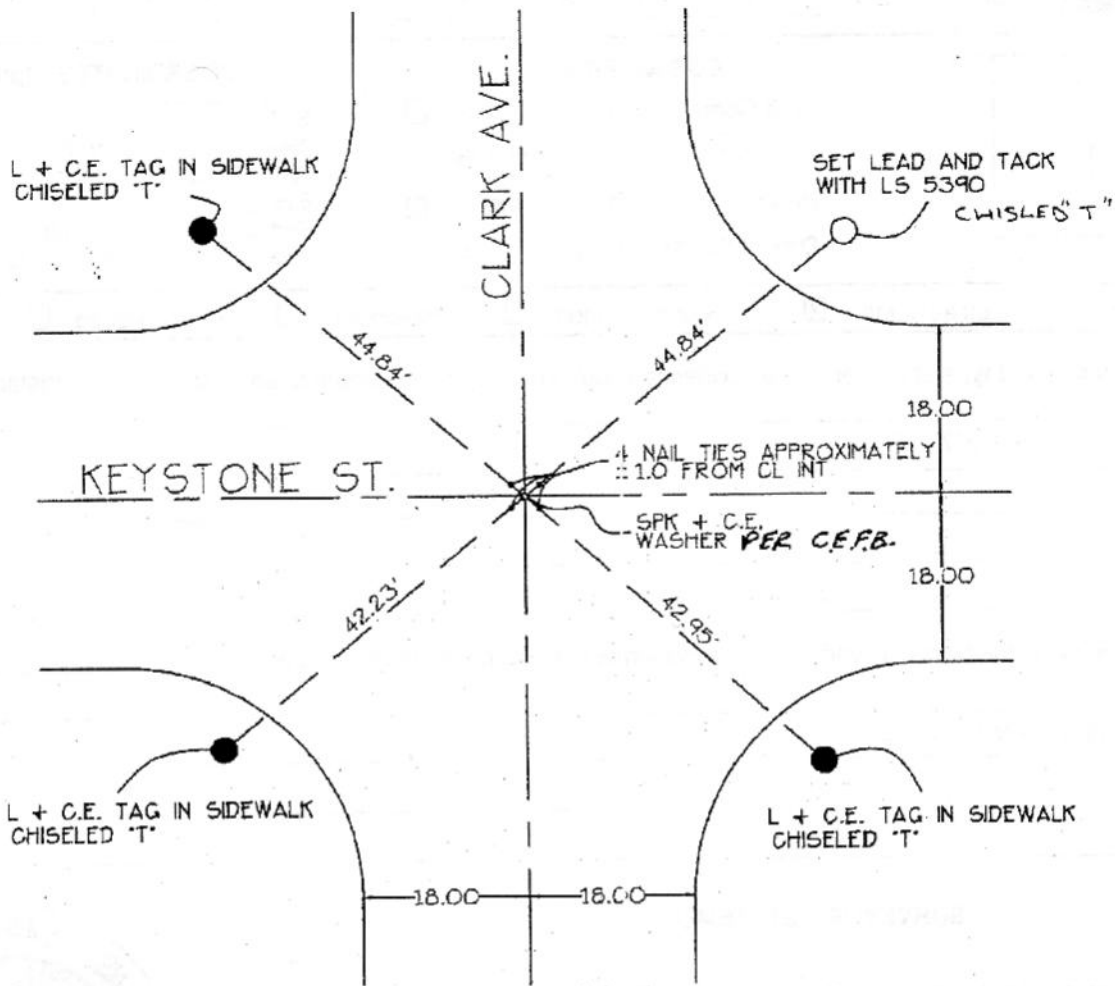

LEGEND

- FOUND AS NOTED
- SET LEAD AND TACK WITH LS 5390
- 4 NAIL TIES APPROXIMATELY ± 1.0 FROM CL INT
- △ SPK + C.E. WASHER



SCALE : 1" = 20'

CORNER RECORD

City of BURBANK

Document Number _____

County of Los Angeles, California

Brief Legal Description KEYSTONE ST. & CLARK AVE - MONUMENT PRESERVATION

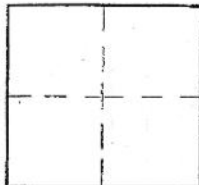

CORNERTYPE

Govt. Corner Control
 Meander Property
 Rancho Other
 Date of Survey APRIL 13, 2004

COORDINATES (Optional)

N. _____
 E. _____
 Zone _____ NAD27 NAD83
 NAD83 Epoch _____
 Elev. _____
 Vert. Datum: NGVD29 NAVD88
 Meas. Units: Metric Imperial

Corner - Left as found Found & tagged Established Reestablished Rebuilt

Identification and type of corner found: Evidence used to identify or procedure used to establish or reestablish the corner:

SEE SHEET 2

A description of the physical condition of the monument as found and as set or reset: _____

SEE SHEET 2

SURVEYOR'S STATEMENT

This Corner Record was prepared by me or under my direction in conformance

with the Land Surveyors' Act on JUNE 9 2004

Signed [Signature] P.L.S. or R.C.E. No. 5390



COUNTY SURVEYOR'S STATEMENT

This Corner Record was received _____

and examined and filed _____

Signed _____ P.L.S. or R.C.E. No. _____

Title: _____

County Surveyor's Comment _____