

R-1= CITY OF BURBANK F.B. 334 P. 29
 () = REC. & MEAS. DIST. PER R-1.

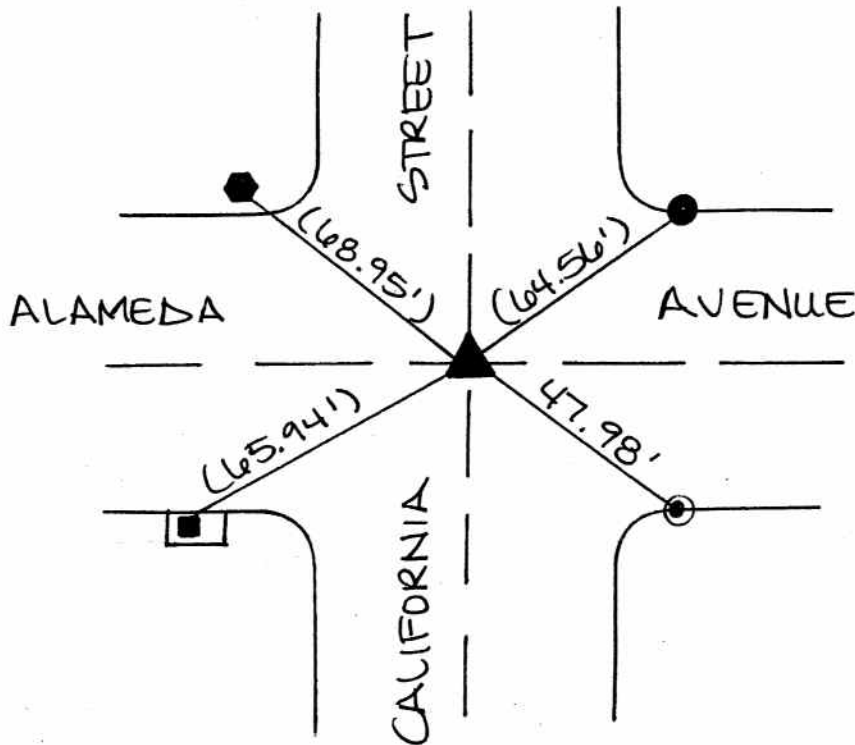

- ▲ FD. SPK & C.E. TAG (PER R-1) PRIOR TO CONSTR.
 SET SPK | W L.S. 5411 AFTER CONSTR.
- FD. L/T IN T.C. (PER R-1)
- FD. L/T C.E. TAG IN C.B. (PER R-1).
- ◆ FD. L/T IN S.W. (PER R-1).
- ◎ SET L/T L.S. 5411 IN T.C.

TIES - FILED AS SUBMITTED

The purpose of this record is to document the perpetuation of found monument(s) pursuant to the PLS Act Section 8771. No claim is made regarding the correctness of the position(s) of said monument(s), nor the dimensional relationship to street centerlines or property boundaries.

06-SEQ-333

CORNER RECORD

PWFB 1618
Document Number

296

City of Burbank County of Los Angeles, California
Brief Legal Description Alameda Avenue & California Street

LA142-16

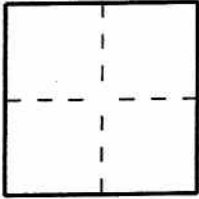

CORNER TYPE

Government Corner Control
Meander Property
Rancho Other
Date of Survey 9/11/06

COORDINATES (Optional)

N. _____
E. _____
Zone _____ NAD27 NAD83
NAD83 Epoch _____
Elevation _____
Vertical Datum: NGVD29 NAVD88
Units: Metric Imperial U.S. Survey

Corner — Left as found Found and tagged Established Reestablished Rebuilt

Identification and type of corner found; Evidence used to identify or procedure used to establish or reestablish the corner:

Found as described on the reverse of this sheet.

A description of the physical condition of the monument as found and as set or reset: _____

See Page 2

SURVEYOR'S STATEMENT

This Corner Record was prepared by me or under my direction in conformance with the Professional Land Surveyors' Act on October 21, 2006

Signed [Signature] P.L.S. or R.C.E. No. L.S. 5411



COUNTY SURVEYOR'S STATEMENT

This Corner Record was received NOV 01 2006
examined and filed NOV 13 2006

Signed [Signature] P.L.S. or R.C.E. No. _____

Title DEPUTY COUNTY SURVEYOR



TIES - FILED AS SUBMITTED

County Surveyor's Comment _____

wt 11-7-06