

FB-335 P. 363

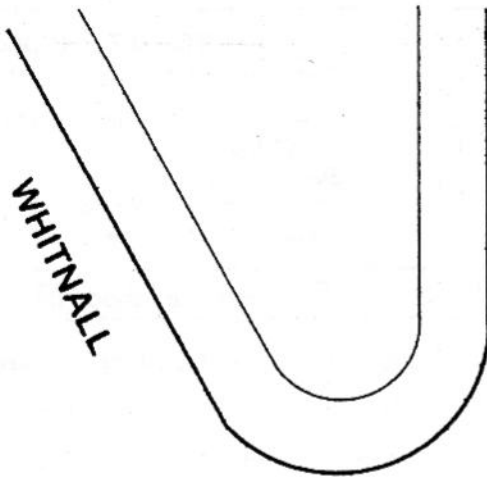

C/L ROSE STREET

WHITNALL

FND L & R IN T.C.

FND L & CE TAG IN WALK

C/L BURBANK BLVD.

50.195' T

56.28'

SET RR SPK, PLS 5691

68.33' T

48.235'

FND L & R IN T.C.

SET L & TAG, PLS 5691, IN WALK; TANGENT TIE; CHISELED 'T'.

HWY.

DATE: SEPT. 8, 2003
SURVEYED BY: J. P. OSTLY
P. L. S. 5691

DISTANCES MEASURED HORIZONTAL

REFERENCE: CEFB 322-5

CORNER RECORD

Document Number 178

City of BURBANK

County of Los Angeles, California

Brief Legal Description BURBANK BLVD. & ROSE ST.- C/L MONUMENT PRESERVATION

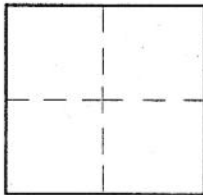

CORNER TYPE

Govt. Corner Control
 Meander Property
 Rancho Other
 Date of Survey 08-Sep-03

COORDINATES (Optional)

N. _____
 E. _____
 Zone _____ NAD27 NAD83
 NAD83 Epoch _____
 Elev. _____
 Vert. Datum: NGVD29 NAVD88
 Meas. Units: Metric Imperial

Corner - Left as found Found & tagged Established Reestablished Rebuilt

Identification and type of corner found: Evidence used to identify or procedure used to establish or reestablish the corner:

see plat;

distances measured horizontal;

A description of the physical condition of the monument as found and as set or reset: _____

see plat;

SURVEYOR'S STATEMENT

This Corner Record was prepared by me or under my direction in conformance
 with the Land Surveyors' Act on October 5, 2003

Signed [Signature] P.L.S. or R.C.E. No. 5691

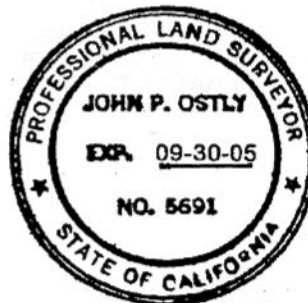

COUNTY SURVEYOR'S STATEMENT

This Corner Record was received OCT 09 2003

and examined and filed OCT 20 2003

Signed Douglas W. Joslin P.L.S. or R.C.E. No. _____

Title: DEPUTY COUNTY SURVEYOR

County Surveyor's Comment OCT 15 2003 TH

