

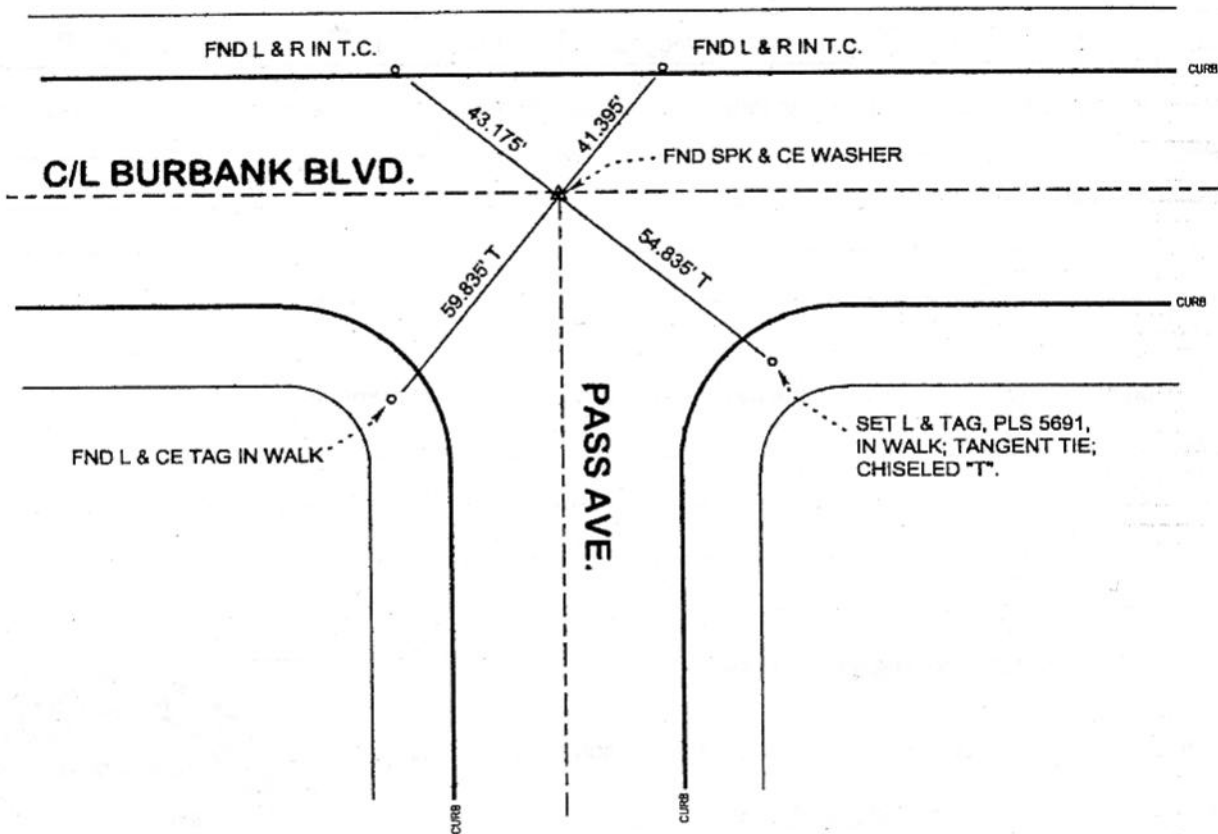

FB-335 P. 381



N. T. S.



DISTANCES MEASURED HORIZONTAL
REFERENCE: CEFB 322-9

DATE: SEPT. 8, 2003
SURVEYED BY: J. P. OSTLY
P. L. S. 5691

CORNER RECORD

Document Number 387

City of BURBANK

County of Los Angeles, California

Brief Legal Description BURBANK BLVD. & PASS AVE. - C/L MONUMENT PRESERVATION



CORNERTYPE

Govt. Corner Control
 Meander Property
 Rancho Other
 Date of Survey 08-Sep-03

COORDINATES (Optional)

N. _____
 E. _____
 Zone _____ NAD27 NAD83
 NAD83 Epoch _____
 Elev. _____
 Vert. Datum: NGVD29 NAVD88
 Meas. Units: Metric Imperial

Corner - Left as found Found & tagged Established Reestablished Rebuilt

Identification and type of corner found: Evidence used to identify or procedure used to establish or reestablish the corner:

see plat;

distances measured horizontal;

A description of the physical condition of the monument as found and as set or reset: _____

see plat;

SURVEYOR'S STATEMENT

This Corner Record was prepared by me or under my direction in conformance with the Land Surveyors' Act on October 5, 2003

Signed [Signature] P.L.S. or R.C.E. No. 5691



COUNTY SURVEYOR'S STATEMENT

This Corner Record was received OCT 09 2003 and examined and filed OCT 20 2003

Signed [Signature] P.L.S. or R.C.E. No. _____
 Title: DEPUTY COUNTY SURVEYOR



County Surveyor's Comment OCT 15 2003 TH