

FB 331 P. 261

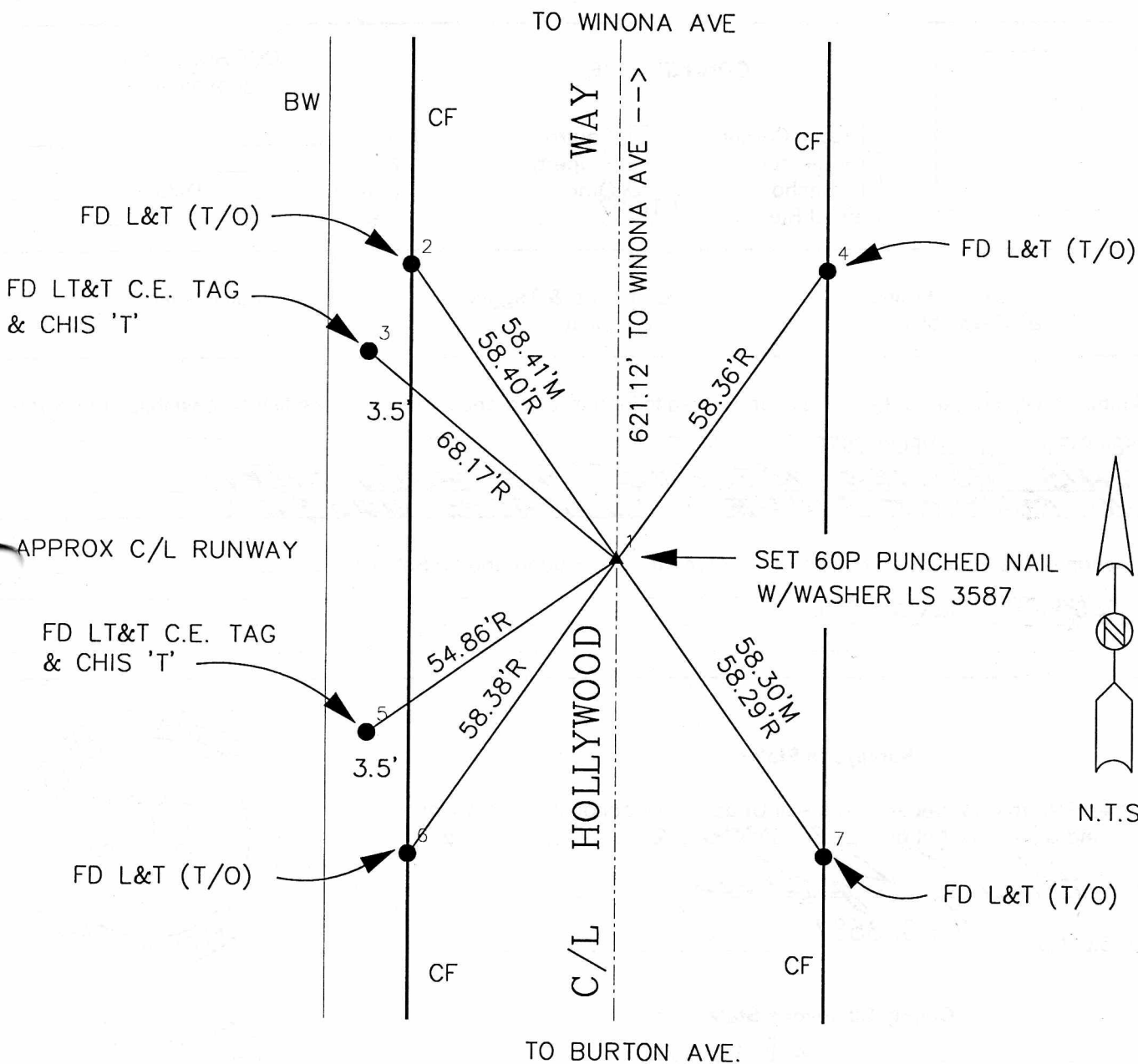

TIES - FILED AS SUBMITTED

CORNER RECORD

FB-331 P. 262

PWFB 1818

220 (A)

INDEX

PAGE

BURBANK

City of _____

County of Los Angeles, California

Brief Legal Description: CENTERLINE INTERSECTION TIES @ HOLLYWOOD WAY.

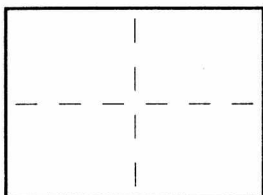

CORNER TYPE

- Govt. Corner
- Meander
- Rancho
- Date of Survey: 3-10-97
- Control
- Property
- Other

COORDINATES (optional)

N. _____
 E. _____
 Zone _____ Datum _____
 Elev. _____

- Corner — Left as Found Found & Tagged Established
 Reestablished Rebuilt

Identification & Type of Corner Found: Evidence used to identify or procedure used to establish or reestablish the corner.

SEE SKETCH ON REVERSE SIDE

THIS CORNER RECORD HAS BEEN FILED TO CORRECT PWFB 1818 PAGES 220 & 231

A Description of the Physical Condition of the Monument as Found and as Set or Reset: _____

SEE SKETCH ON REVERSE SIDE

Surveyor's Statement

This Corner Record was Prepared by Me or Under My Direction in Conformance with the Land Surveyors Act on MARCH 10 19 97.

Signed: Kris Joseph Rigdon

L.S. or R.C.E. No.: L.S. 3587



County Surveyor's Statement

This Corner Record was Received APR 16 1997 and Examined and Filed APR 29 1997 19 ____.

Signed: Paul M. Smith

Title: DEPUTY COUNTY SURVEYOR



County Surveyor's Comment: **TIES - FILED AS SUBMITTED**