

**City of Burbank
Public Works Engineering**

Type of Survey: TRANSIT TIES F.B.: 331 Pg.: 121

Surveyed by: ORTEGA, STEAD, VILLARAMA Date: JUN. 12, 1991

Tract or Parcel Map No.: SIXTH ST. & ROSELLI ST. Work Order No.: _____

NOTE:
Additions or changes
must be initiated or
dated.

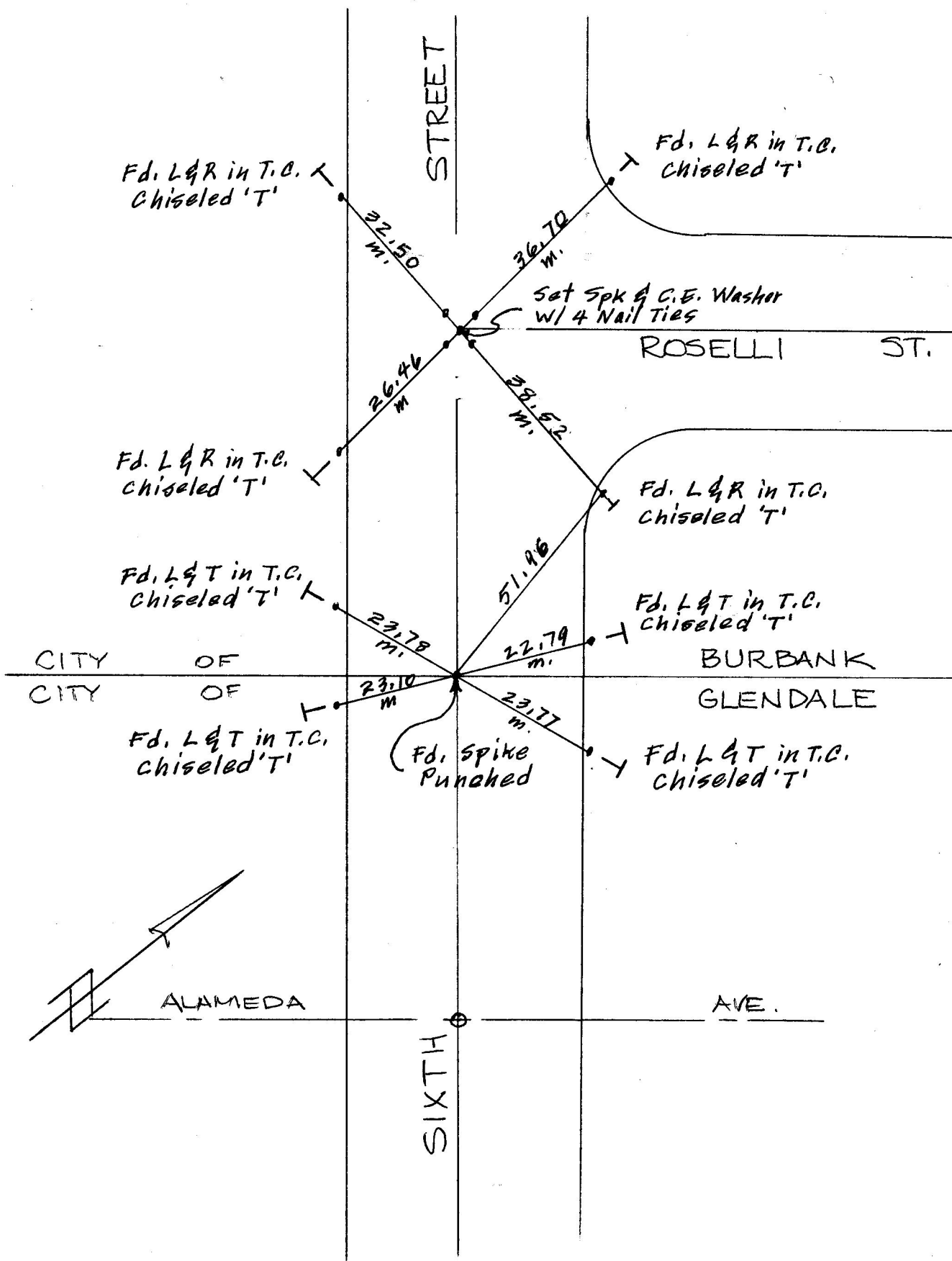

Return Originals To:
City of Burbank
Public Works Engineering
Survey Division
275 E. Olive Ave., Burbank, CA 91502 -1267