

322

ALAMEDA & TIES

149

FD. L & C.E. TAG  
PER BK # 522  
(FITS MEAS.)

SET L & C.E. TAG  
IN PED. RAMP  
"T"

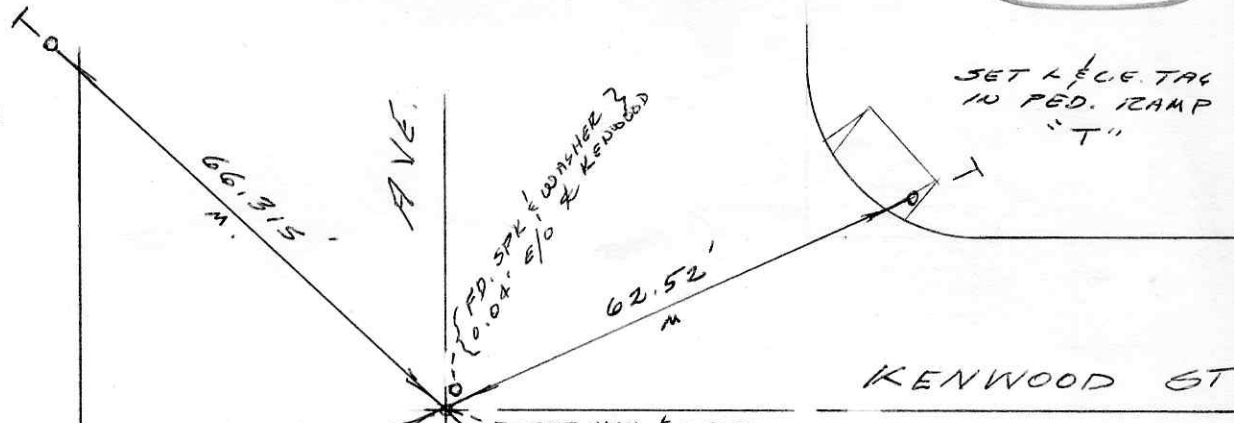

SET L & C.E. TAG  
IN SIDEWALK  
"T"

KENWOOD ST

RESET TIES  
AFTER CONSTRUCTION.  
FEB. 24, 1989

SET L & C.E. TAG  
IN PCC SIDEWALK  
"T"

SET L & C.E.  
TAG IN PCC  
SIDEWALK

SET L & C.E.  
TAG IN  
PED. RAMP  
"T"

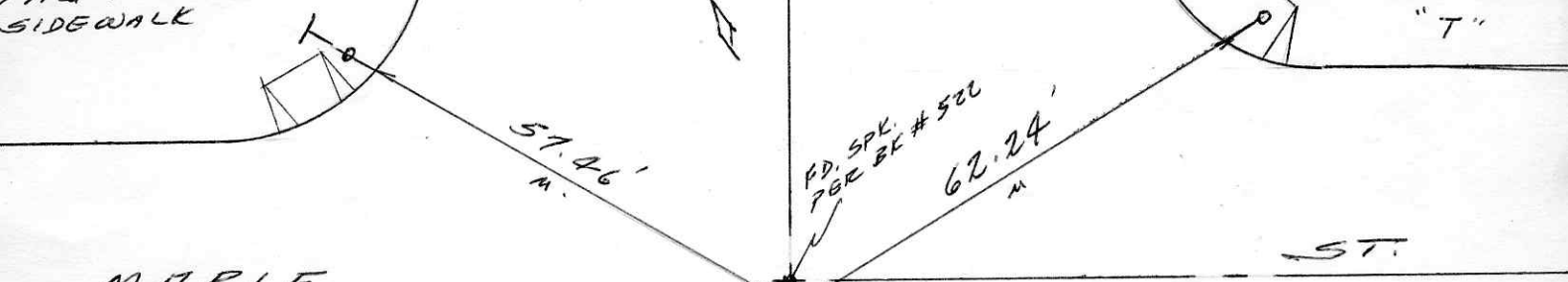

MAPLE

SPL. FD. PER  
OLD TIES  
F.B. # 43  
& F.B. # 522  
57.78  
M.

ST.

SET L & C.E. TAG  
IN PED. RAMP  
"T"

SET L & C.E. TAG  
IN ~~PED~~ PCC  
SIDEWALK  
"T"